



## P8AX25-6G-SMA/FF

- RF coaxial surge protector
- 6 GHz
- 240 W
- Connectors : SMA
- Low insertion loss
- Removable GDT
- DC-pass
- Bi-directional protection



| Electrical Characteristics  |           |                 |
|---|-----------|-----------------|
| Operating current<br><i>Continuous current at <math>U_c</math></i>                | $I_c$     | none            |
| Max. discharge current<br><i>max. withstand @ 8/20 <math>\mu</math>s by pole</i>  | $I_{max}$ | 20 kA           |
| Max. load current   | $I_L$     | 10A             |
| Protection mode(s)  |           | MC              |
| Protection level<br><i>@ <math>I_n</math> (8/20<math>\mu</math>s)</i>             | $U_p$     | < 2300 V        |
| Impulse current<br><i>2 x 10/350<math>\mu</math>s Test - D1 Category</i>          | $I_{imp}$ | 1 kA            |
| Nominal discharge current<br><i>8/20<math>\mu</math>s Test x 10 - C2 Category</i> | $I_n$     | 5 kA            |
| Max. frequency  | $f$       | 7 GHz           |
| Impedance   |           | 50 ohms         |
| Insertion loss  |           | < 0.3dB         |
| Max Power   |           | 240 W           |
| Return loss   |           | > 18 dB         |
| VSWR  |           | <1.3:1          |
| Insulation resistance   |           | $\geq 10$ GOhms |

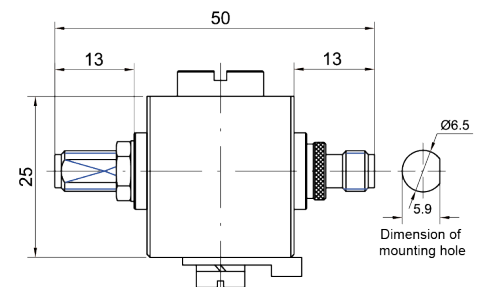



| Mechanical Characteristics        |  |
|-----------------------------------|--|
| Technology                        | Gas discharge tube                           |
| Connection to Network             | Connector SMA<br>Female/Female               |
| Mounting                          | Feedthrough                                  |
| Housing material                  | Brass/Surface plating : Cu Zn Sn             |
| Operating temperature             | -40/+85°C                                    |
| Protection rating                 | IP66   |
| Failsafe behavior                 | Short-circuit                                |
| Disconnection indicator           | transmission interrupt                       |
| Spare module                      | 2 x BA HF - 150/20                           |
| Remote signaling of disconnection | -  |
| Contacts                          | Bronze/Surface Au-Ag                         |
| Insulation material               | PTFE   |
| Norms                             |  |
| Standards compliance              | IEC 61643-21 / EN 61643-21 / UL497C / UL497E |
| Code article                      |  |
|                                   | 68514  |