



## P8AX09-6G-SMA/FF

- RF coaxial surge protector
- 6 GHz
- 70 W
- Connectors : N
- Low insertion loss
- Removable GDT
- DC-pass
- Bi-directional protection



Electrical Characteristics		
Operating current <i>Continuous current at <math>U_c</math></i>	$I_c$	none
Max. discharge current <i>max. withstand @ 8/20 <math>\mu</math>s by pole</i>	$I_{max}$	20 kA
Max. load current	IL	10A
Protection mode(s)		MC
Protection level <i>@ <math>I_n</math> (8/20<math>\mu</math>s)</i>	$U_p$	< 1100 V
Impulse current <i>2 x 10/350<math>\mu</math>s Test - D1 Category</i>	$I_{imp}$	1 kA
Nominal discharge current <i>8/20<math>\mu</math>s Test x 10 - C2 Category</i>	$I_n$	5 kA
Max. frequency	f	7 GHz
Impedance		50 ohms
Insertion loss		< 0.3dB
Max Power		70 W
Return loss		> 18 dB
VSWR		<1.3:1
Insulation resistance		$\geq 10$ GOhms

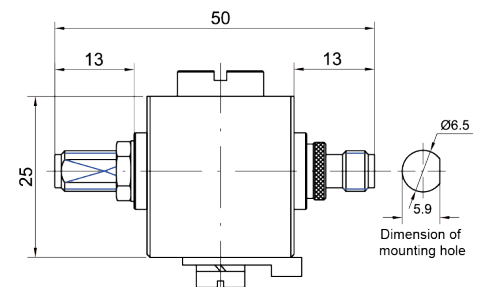



Mechanical Characteristics	
Technology	Gas discharge tube
Connection to Network	Connector SMA Female/Female
Mounting	Feedthrough
Housing material	Brass/Surface plating : Cu Zn Sn
Operating temperature	-40/+85°C
Protection rating	IP66
Failsafe behavior	Short-circuit
Disconnection indicator	transmission interrupt
Spare module	2 x BA HF - 90/20
Remote signaling of disconnection	-
Contacts	Bronze/Surface Au-Ag
Insulation material	PTFE
Norms	
Standards compliance	IEC 61643-21 / EN 61643-21 / UL497C / UL497E
Code article	
	68511