

Type	C3-X1x/ ... V Power relays for DC application 1 pole, NO, double make		
-------------	--	--	--

Maximum contact load	10 A/250 V AC-1	7 A/110 V DC-1
	10 A/30 V DC-1	1,2 A/220 V DC-1

Contacts			
Material	Standard	Code 0	AgNi
Rated current			10 A
Switch-on current max. (20 ms)			30 A
Switching voltage max.			250 V
AC load (Fig 1)			2,5 kVA
DC load			see Fig. 2

Coil	
Coil resistance	see table; tolerance $\pm 10\%$
Pick-up voltage	$\leq 0,8 \times U_N$
Release voltage	$\geq 0,1 \times U_N$
Nominal power	2,4 VA (AC)/1,3 W (DC)

Coil table						
VAC	Ω	mA	VDC	Ω	mA	
24	65	100	24	480	54	
48	286	50	48	1K8	26	
115	1K7	21	110	9K	12	
230	6K8	10	220	29K	7,5	

Insulation	
Contact open	Volt rms, 1 min
Contact/contact	2500 V
Contact/contact	2,5 kV
Contact/coil	2,5 kV
Insulation resistance at 500 V	$\geq 1 \text{ G}\Omega$
Insulation, IEC 61810-1	2,5 kV/3

Specifications	
Ambient temperature operation/storage	-40 (no ice)...60 °C / -40 ... 80 °C
Pick-up time/bounce time	18 ms/ ≤ 3 ms
Release time/bounce time	8 ms/ ≤ 1 ms
Mechanical life ops	AC: 10 Mill./DC: 20 Mill.
DC voltage endurance at rated load	≥ 100000 switching cycles
Switching frequency at rated load	≤ 1200 /ops/h
Protection class	IP40
Weight	83 g

Standard types
VAC 50 Hz/60 Hz: 24, 48, 115 (120), 230 (240) LED

C3-X10/AC ... V
C3-X10X/AC ... V

VDC 24, 48, 110, 220 LED

C3-X10/DC ... V
C3-X10X/DC ... V
C3-X10DX/DC ... V
C3-X10FX/DC ... V

Free wheeling diode
Polarity and free wheeling diode

C3-X10BX/UC ... V

AC/DC bridge rectifier 24 V, 48 V, 60 V

"..." Enter the voltage for full type designation

Accessories	
Socket:	S3-B, S3-S, S3-L, S3-P, S3-P0
Optional accessories (blanking plug):	SO-NP, SO-OP
Retaining clip, plastic:	S30-CM

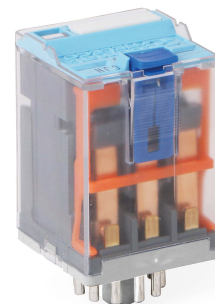

Connection diagram

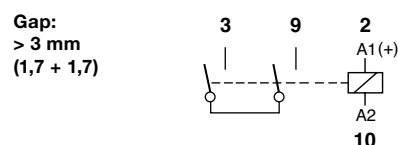

Fig. 1 AC voltage endurance

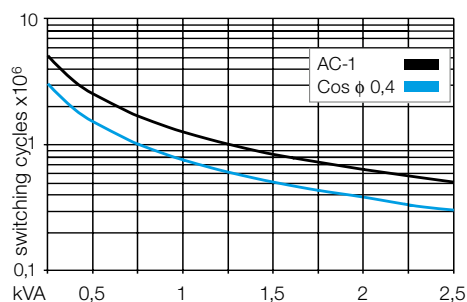
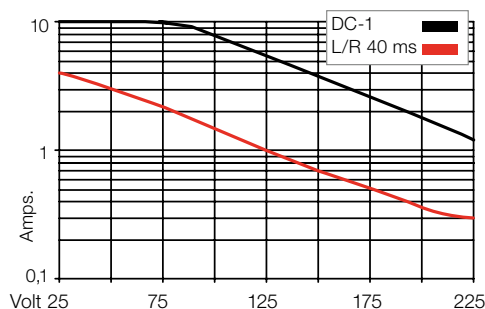
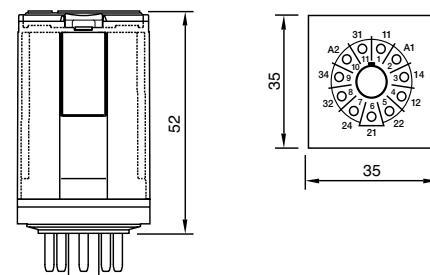

Fig. 2 DC load limit curve



Dimensions [mm]



Technical approvals, conformities



IEC 61810; EN 60947