

<b>Type</b>	<b>C3-M1x/ ... V</b> Power relays, DC, application 1 pole, magnetic blow out
-------------	--

<b>Maximum contact load</b>	<b>10 A 250 V AC-1    10 A 220 V DC-1</b>
-----------------------------	---

**Contacts**

Material	Standard	Code 0	AgNi
Rated current			10 A
Switch-on current max. (20 ms)			30 A
Switching voltage max.			250 V
AC load (Fig 1)			2,5 kVA
DC load			see Fig. 2

**Coil**

Coil resistance	see table; tolerance $\pm 10\%$
Pick-up voltage	$\leq 0,8 \times U_N$
Release voltage	$\geq 0,1 \times U_N$
Nominal power	2,4 VA (AC) / 1,3 W (DC)

**Coil table**

VAC	$\Omega$	mA	VDC	$\Omega$	mA
24	65	100	24	480	50
48	286	50	48	1K8	26
115	1K7	21	110	9K	12
230	6K8	10	220	29K	7,5

**Insulation**

	Volt rms, 1 min
Contact open	2500 V
Contact/contact	2,5 kV
Contact/coil	2,5 kV
Insulation resistance at 500 V	$\geq 1$ G $\Omega$
Insulation, IEC 61810-1:	2,5 KV / 3

**Specifications**

Ambient temperature operation/storage	-40 ... 70 °C (55° C AC) / -40 ... 80 °C
Nominal coil power	2,4 VA (AC), 1,3 W (DC)
Pick-up time/bounce time	20 ms/ $\leq 3$ ms
Release time/bounce time	10 ms/ $\leq 1$ ms
Isolation: EN 60947, pollution rate 3, Gr C	250 V
Dielectric strength, Contact/Coil	2,5 kV

**Standard types**

**VAC 50 Hz/60 Hz: 24, 48, 115 (120), 230 (240) LED**

**C3-M10/AC ... V**  
**C3-M10X/AC ... V**

**VDC 24, 48, 110, 220 LED**

**C3-M10/DC ... V**  
**C3-M10X/DC ... V**  
**C3-M10DX/DC ... V**  
**C3-M10FX/DC ... V**

**Free wheeling diode**

**Polarity and free wheeling diode**

**AC/DC bridge rectifier 24 V, 48 V, 60 V**

**C3-M10BX/UC ... V**

"..." Enter the voltage for full type designation

**Accessories**

Socket:	<b>S3-B, S3-S, S3-L, S3-P, S3-P0</b>
Optional accessories (blanking plug):	<b>SO-NP, SO-OP</b>
Retaining clip, plastic:	<b>S30-CM</b>

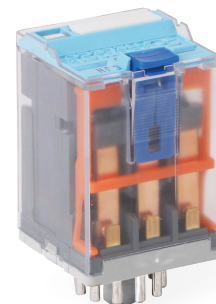
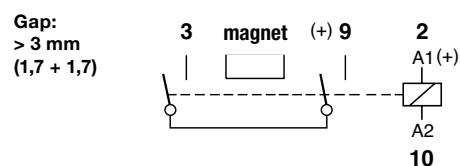
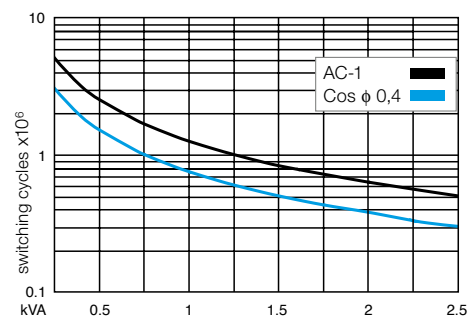
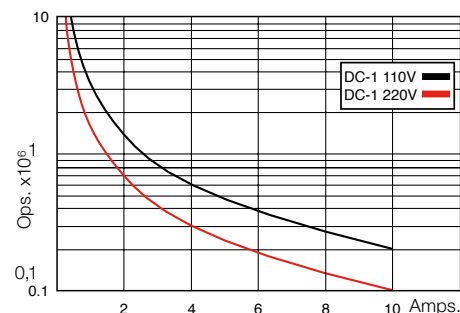
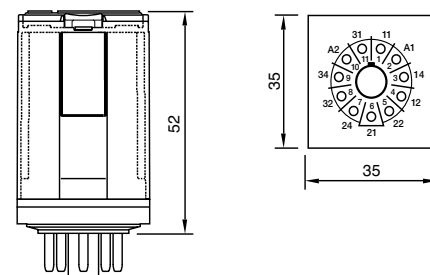
**Connection diagram****Fig. 1 AC voltage endurance****Fig. 2 DC voltage endurance****Dimensions [mm]****Technical approvals, conformities**

IEC 61810; EN 60947