

<b>Type</b>	<b>C3-G3x/ ... V</b> Standard relays, DC application 3 open contacts		
-------------	--	--	--

<b>Maximum contact load</b>	<b>10 A 250 V AC-1</b>	<b>1,2 A/110 V DC-1</b>
	<b>10 A 30 V DC-1</b>	<b>0,4 A/220 V DC-1</b>

**Contacts**

Material	Standard	Code 0	AgNi
Rated current			10 A
Switch-on current max. (20 ms)			30 A
Switching voltage max.			250 V
AC load (Fig 1)			2,5 kVA
DC load			see Fig. 2

**Coil**

Coil resistance	see table; tolerance ± 10 %
Pick-up voltage	≤ 0,8 x U <sub>N</sub>
Release voltage	≥ 0,1 x U <sub>N</sub>
Nominal power	2,4 VA (AC)/1,6 W (DC)

**Coil table**

VAC	Ω	mA	VDC	Ω	mA
24	65	100	24	360	66
48	286	50	48	1K4	34
115	1K7	21	110	7K6	15
230	6K8	10	220	30K3	7,5

**Insulation**

	Volt rms, 1 min
Contact open	2000 V
Contact/contact	2,5 kV
Contact/coil	2,5 kV
Insulation resistance at 500 V	≥ 1 GΩ
Insulation, IEC 61810-1	2,5 kV/3

**Specifications**

Ambient temperature operation/storage	-40 (no ice)...60 °C / -40 ... 80 °C
Pick-up time/bounce time	20 ms/≤ 3 ms
Release time/bounce time	8 ms/≤ 1 ms
Mechanical life ops	AC: 10 Mill./DC: 20 Mill.
DC voltage endurance at rated load	≥ 100000 switching cycles
Switching frequency at rated load	≤ 1200/ops/ h
Protection class	IP40
Weight	81 g

**Standard types**

**VAC 50 Hz/60 Hz: 24, 48, 115 (120), 230 (240)**

**LED**

**VDC 24, 48, 110, 220**

**LED**

**Free wheeling diode**

**Polarity and free wheeling diode**

**AC/DC bridge rectifier 24 V, 48 V, 60 V**

**C3-G30/AC ... V**  
**C3-G30X/AC ... V**

**C3-G30/DC ... V**  
**C3-G30X/DC ... V**  
**C3-G30DX/DC... V**  
**C3-G30FX/DC ... V**

**C3-G30BX/UC ... V**

"..." Enter the voltage for full type designation

**Accessories**

Socket:	<b>S3-B, S3-S, S3-L, S3-P, S3-P0</b>
Optional accessories (blanking plug):	<b>SO-NP, SO-OP</b>
Retaining clip, plastic:	<b>S30-CM</b>

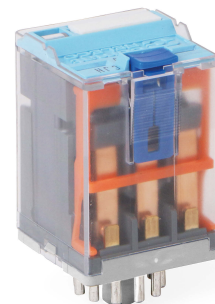

**Connection diagram**

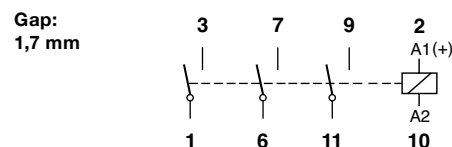

**Fig. 1 AC voltage endurance**

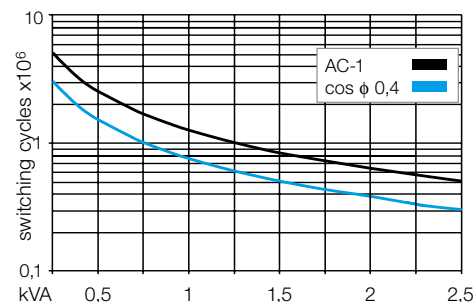

**Fig. 2 DC load limit curve**

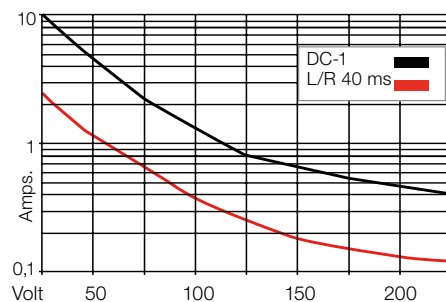

**Dimensions [mm]**

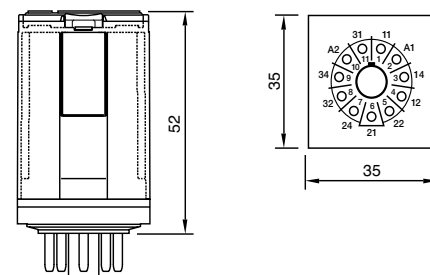

**Technical approvals, conformities**



IEC 61810; EN 60947